

PCB LAYOUT
TOP VIEW

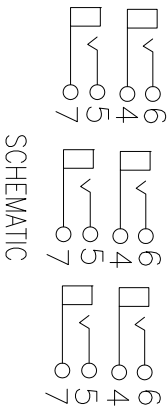

SCHEMATIC

REV.	ECN NO.	MODIFIED MARK	APPROVED
A		FIRST RELEASE	

- NOTES:
- ELECTRICAL:
- 1: RATED CURRENT: 0.2A Max.
 - 2: RATED VOLTAGE: 50V AC.
 - 3: CONTACT RESISTANCE: 50 MILLIOHMS Max.
 - 4: INSULATION RESISTANCE: 100 MEGAOHMS Min.
 - 5: DIELECTRIC WITHSTANDING VOLTAGE: 500 VAC Min.
- MECHANICAL:
- 1: INSERTION FORCE: 3N-30N.
 - 2: WITHDRAWAL FORCE: 3N-30N.
 - 3: DURABILITY: 100 CYCLES.
- ENVIRONMENTAL:
- TEMPERATURE RANGE: -20°C TO 60°C.

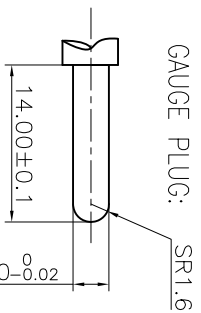

GUAGE PLUG: SR1.6

ANGLE	±5°
$63 < L$	±0.5
$16 < L \leq 63$	±0.4
$4 < L \leq 16$	±0.3
$L \leq 4$	±0.2

TOL TABLE:

THIS DOCUMENT IS THE PROPERTY OF TREPRO TECHNOLOGY CO., LTD. NO PART THEREOF MAY BE REPRODUCED AND USED WITHOUT THE PRIOR WRITTEN CONSENT OF THE OWNER

MODEL NAME: RCA-613F (PART NO.)		TITLE: RCA PIN JACK	
DESIGN: X.H.Wang 11/24'18		DWG NO.:	
CHECKED: L.W.Wu 11/24'18		REV.: A	
Q'TY: /	APPROVED: X.Q.Hu 11/24'18	UNIT: mm	SCALE: 5:1
FINISH: See table	VIEW: 1/1	SHEET: 1/1	SIZE: A3



广东正宝科技有限公司
GUANGDONG TREPRO TECHNOLOGY CO., LTD.