

REV.	ECN NO.	MODIFIED MARK	APPROVED
A		FIRST RELEASE	

NOTES:

ELECTRICAL:

- 1: RATED CURRENT: 0.2A Max.
- 2: RATED VOLTAGE: 50V AC.
- 3: CONTACT RESISTANCE: 30 MILLIOHMS Max. AFTER TESTING: 100 MILLIOHMS Max.
- 4: INSULATION RESISTANCE: 100 MEGAOHMS Min.
- 5: DIELECTRIC WITHSTANDING VOLTAGE: 500 VAC Min.

MECHANICAL:

- 1: INSERTION FORCE: 3N-30N.
- 2: WITHDRAWAL FORCE: 3N-30N.
- 3: DURABILITY: 100 CYCLES.

ENVIRONMENTAL:

TEMPERATURE RANGE: -20°C TO 60°C.

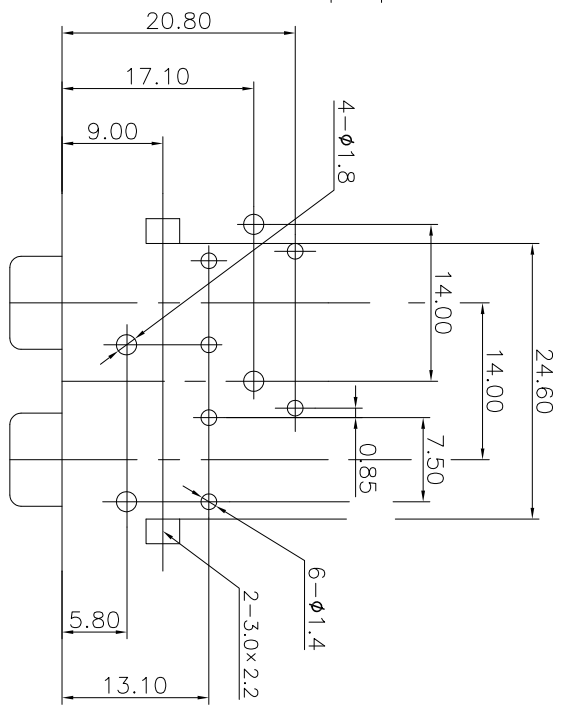
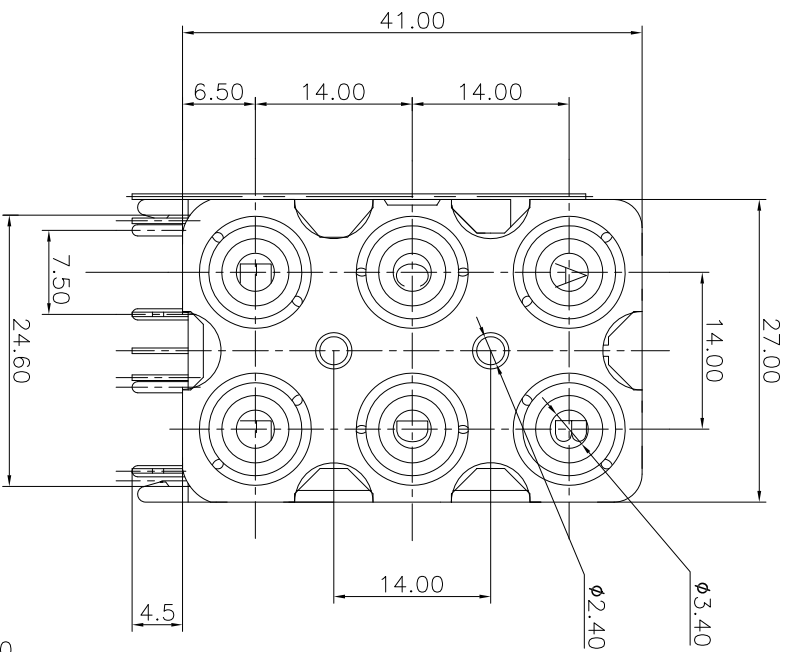
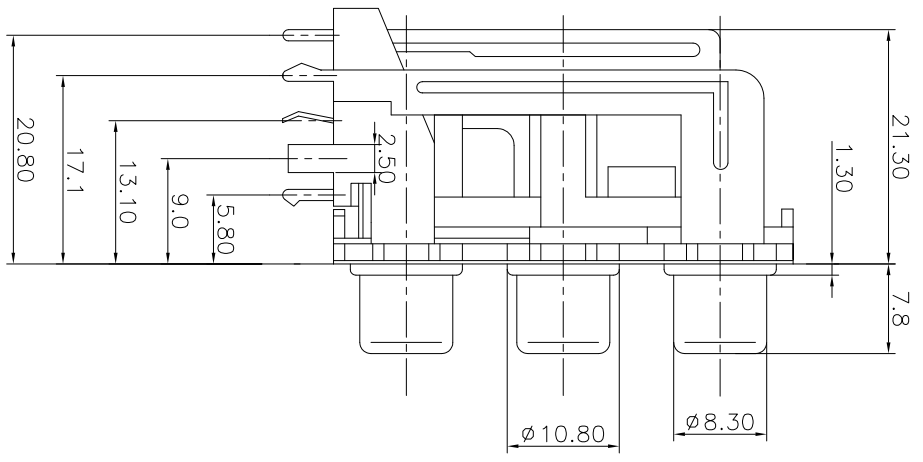

PCB LAYOUT
TOP VIEW

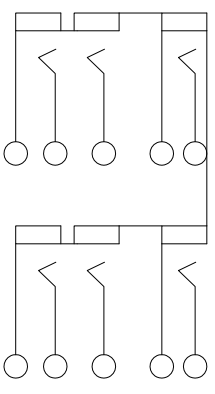
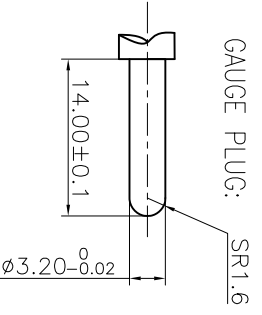

ANGLE	±5°
63 < L	±0.5
16 < L ≤ 63	±0.4
4 < L ≤ 16	±0.3
L ≤ 4	±0.2

TOL TABLE:

THIS DOCUMENT IS THE PROPERTY OF TERPRO TECHNOLOGY CO., LTD. NO PART THEREOF MAY BE REPRODUCED AND USED WITHOUT THE PRIOR WRITTEN CONSENT OF THE OWNER

MODEL NAME: RCA-613A/P (PART NO.)	DESIGN: X.H.Wang	TITLE: RCA PIN JACK
MAT'L: See table	CHECKED: L.W.Wu	DWG NO.:
FINISH: See table	APPROVED: X.Q.Hu	DATE: 11/24/18
Q'TY: /	UNIT: mm	SCALE: 5:1
	VIEW: 1/1	SHEET: 1/1
	REV: A	SIZE: A3

广东正宝科技有限公司
GUANGDONG TERPRO TECHNOLOGY CO., LTD.